

# 2310 Peachtree Parkway

2310 Peachtree Parkway  
Cumming, GA 30041



FOR  
LEASE



## Leasing Contacts

Allie Hodge Motz  
678-501-5342  
allie@riverwoodproperties.com

[riverwoodproperties.com](http://riverwoodproperties.com)

## Property Highlights

- This proposed development is located on State Route 141 in Cumming, GA, less than 1 mile from Target, Home Depot, and other major retailers.
- The property sits on 7.6 acres in the heart of Georgia's Technology Corridor.
- The site offers great visibility, and the population is over three times the national average.
- This growing retail corridor sees over 30,300 VPD and is an ideal location for any retailer.
- Zoned CBD | Commercial Business District
- Proposed Building 2 | 13,000 SF | Retail/Restaurant Spaces Available
- Proposed Building 3 | 5,250 SF | Retail/Restaurant Spaces Available

# 2310 PEACHTREE PARKWAY

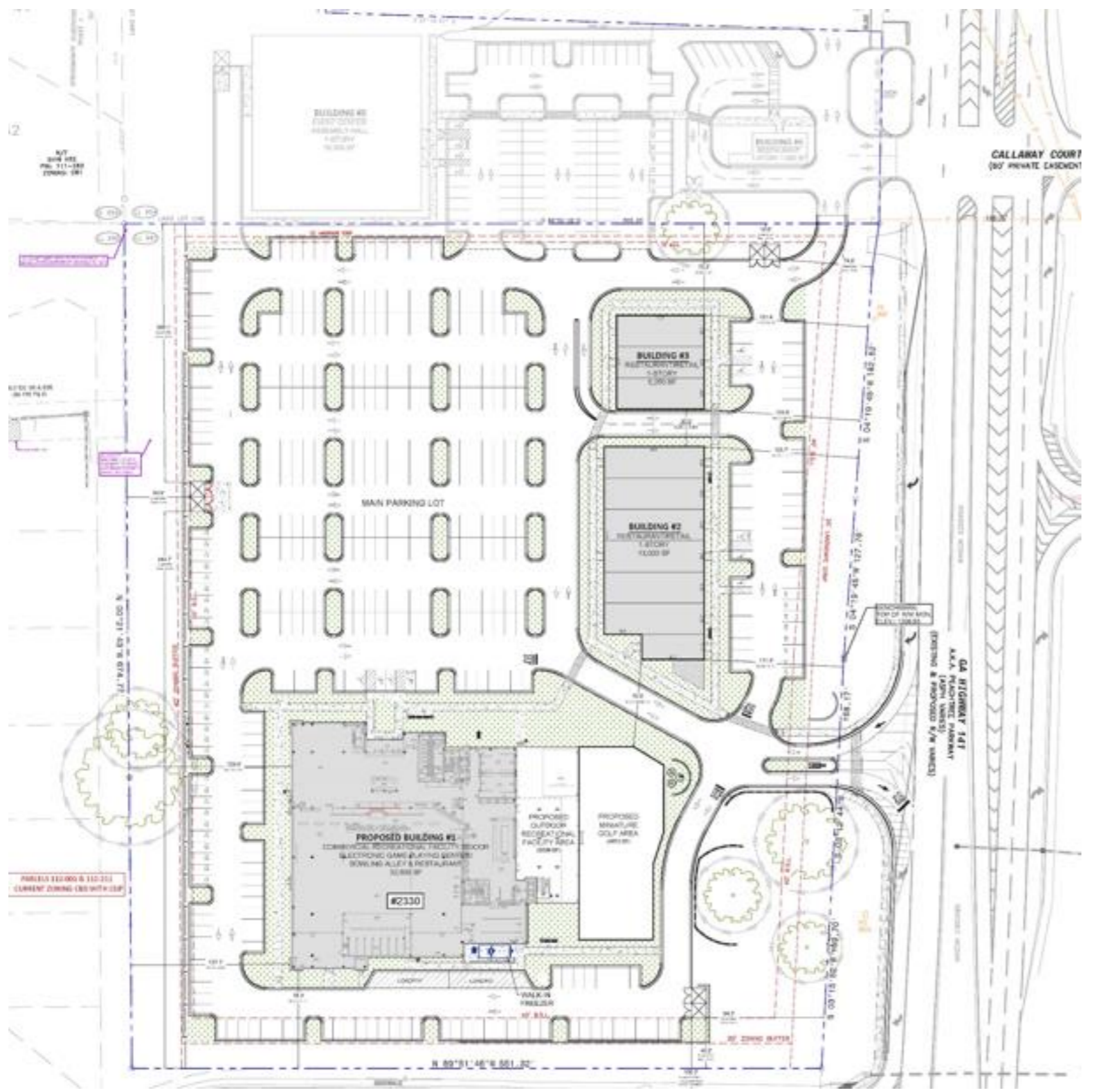

Building 2	Retail / Restaurant Space Available	Up to 13,000
Building 3	Retail / Restaurant Space Available	Up to 5,250 SF
GLA:		18,250
Availability:		Up to 13,000

# 2310 PEACHTREE PARKWAY

Site Plan

# AREA DEMOGRAPHICS



2023  
Population

1 MILE	6,568
3 MILE	65,119
5 MILE	177,343



2023 Daytime  
Population

1 MILE	1,642
3 MILE	32,034
5 MILE	105,727



Household 2023

1 MILE	2,084
3 MILE	20,939
5 MILE	59,430



Household  
Income

1 MILE	\$238,897
3 MILE	\$239,030
5 MILE	\$201,716

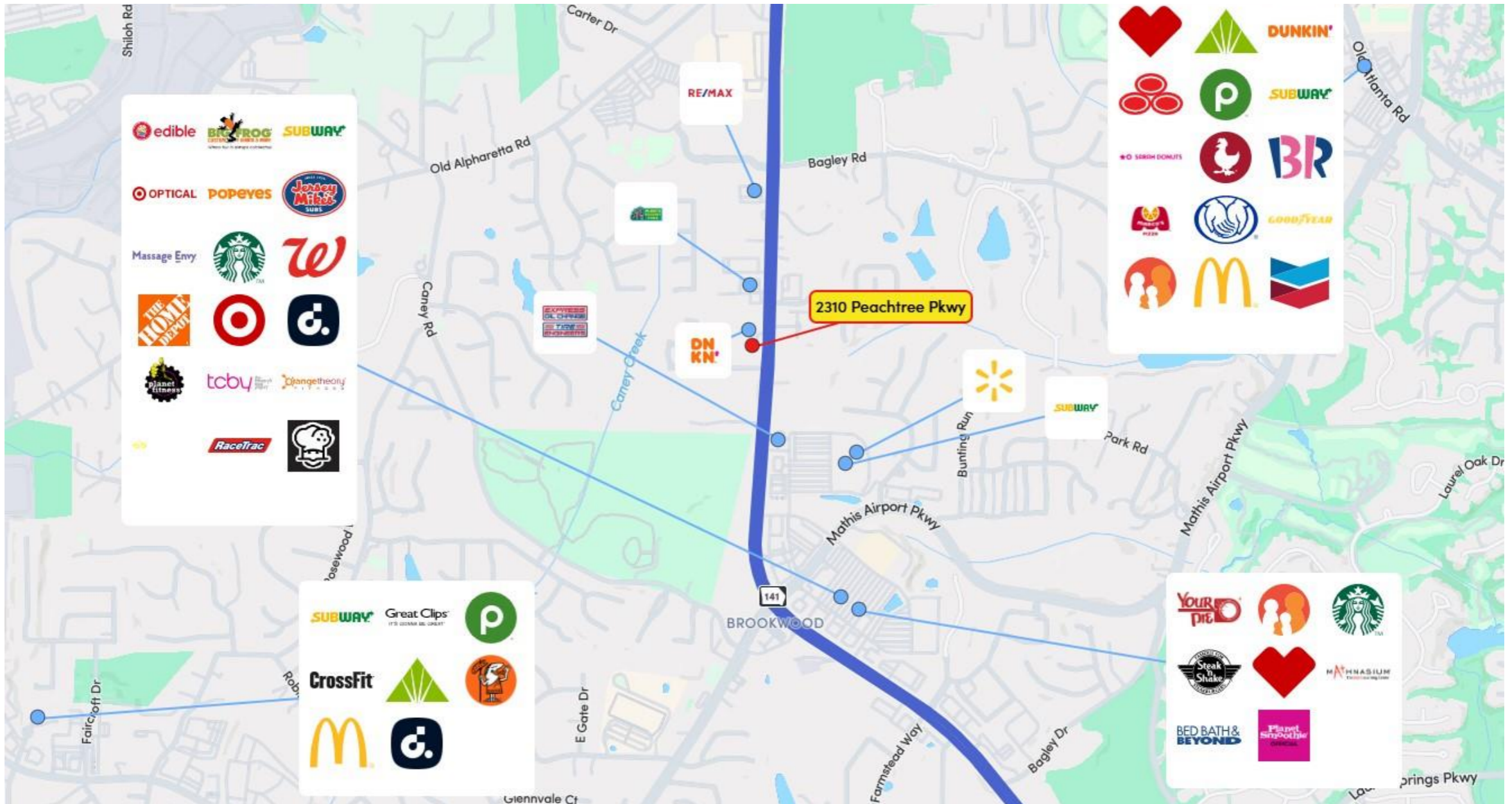

## 2310 PEACHTREE PARKWAY

Trade Area Overview

# TRADE AREA OVERVIEW



## 2310 PEACHTREE PARKWAY

Trade Area Overview