

# Gainesville Development

400 Crescent Dr,  
Gainesville, GA 31008

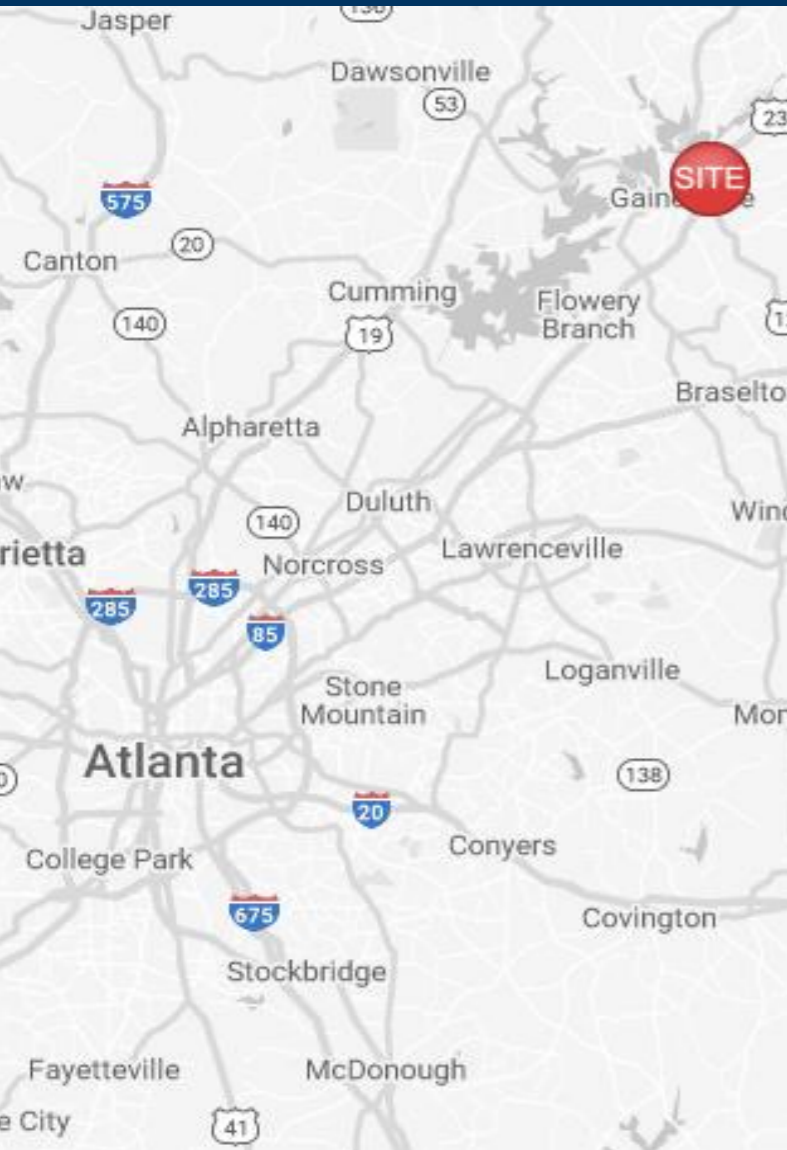

## AREA DEMOGRAPHICS



2021  
Population

1 MILE	2,538
3 MILE	27,583
5 MILE	61,867



2021 Daytime  
Population

1 MILE	1,679
3 MILE	26,476
5 MILE	45,886



Household 2021

1 MILE	1,001
3 MILE	9,707
5 MILE	20,622



Household  
Income

1 MILE	\$63,084
3 MILE	\$70,257
5 MILE	\$72,092



### Leasing Contacts

Marrissa Chanin  
678-501-5341  
Marrissa@riverwoodproperties.com

Allie Hodge  
678-501-5342  
ahodge@riverwoodproperties.com

### Property Highlights

Come join Dunkin' in a new retail development in Gainesville, GA directly off Jesse Jewell Pkwy and next to I-985. The multi-tenant development will sit in front of a Homewood Suites hotel offering great visibility and accessible by a curb cut off Crescent Dr. The site is located in Gainesville's largest retail corridor and sees an average of 31,000 vehicles per day. It is in close proximity to Lanier Tech's Campus and Northeast Georgia Regional medical center who recently announced plans to add an additional 927,000 SF to their footprint.



# Gainesville Development

## TENANTS

100 Dunkin 2,070

101-102 Retail Space Available 1,500-4,000

GLA: 6,070 SF

Available: up to 4,000 SF

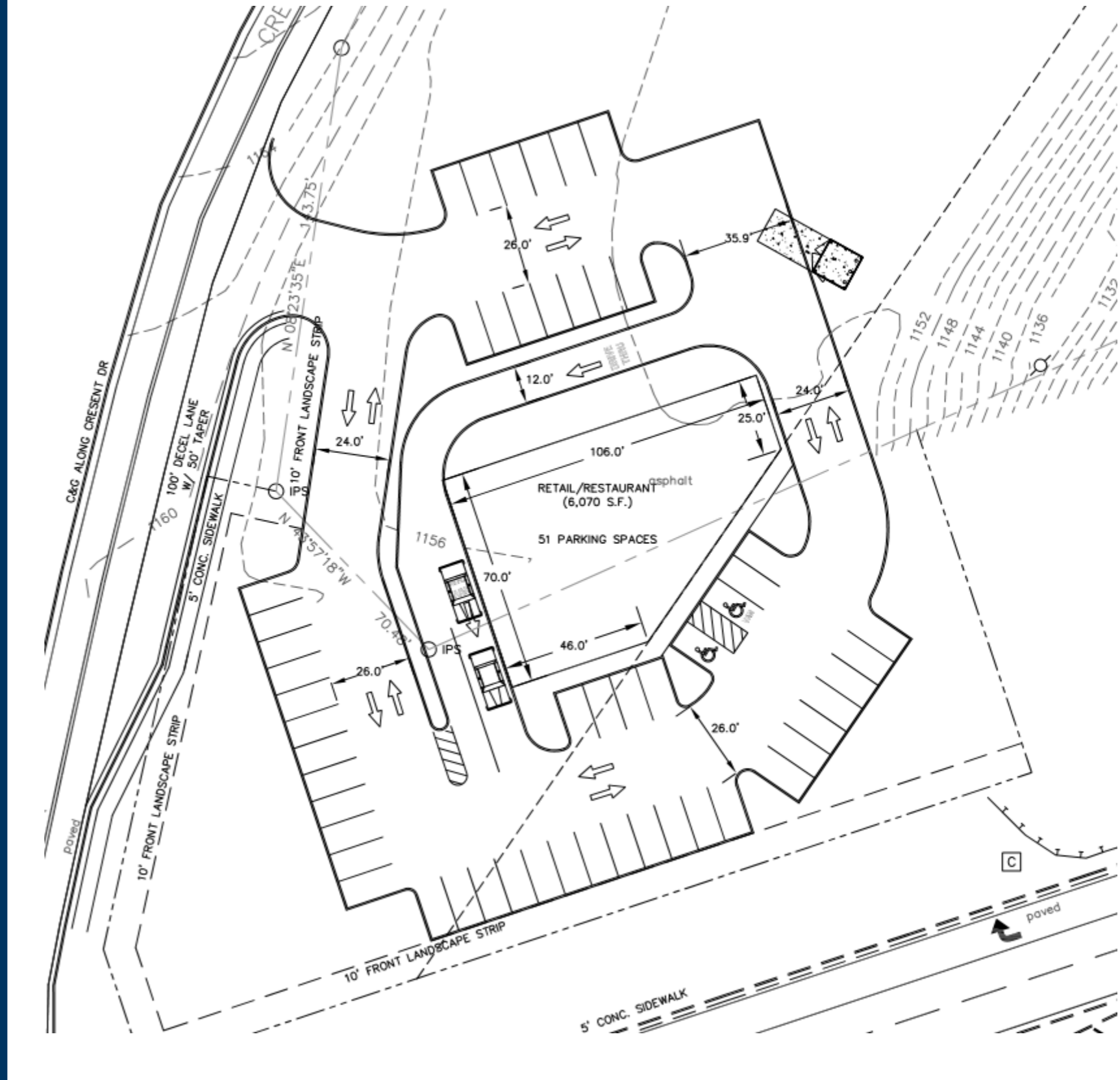

# GAINESVILLE DEVELOPMENT

## Site Plan

